

# INSTRUCTION MANUAL

## ELOFLEX K

Read this documentation before using your Eloflex to make sure that you use it in a manner that is safe, and which does not harm you, your environment or your power wheelchair.



ELOFLEX

# Thank you and good luck!

---

Thank you for choosing an Eloflex as your aid. It means a lot to us because our vision is to make peoples' everyday lives a little easier and to give people with mobility impairments more freedom. We hope you experience both with the help of your Eloflex.

We think you will be very pleased with your new power wheelchair. This user manual contains important information on safety, use and care. We urge you to read this entire documentation before using your Eloflex for the first time. We also suggest that you practice driving your Eloflex on a separate, open and flat surface before using it in other contexts.

The Eloflex power wheelchair is designed for users with many different needs. The decision as to whether Eloflex is suitable for the user is always made by the prescriber or retailer together with the user. Eloflex assumes no responsibility for cases where the power wheelchair is not adapted to the user's needs.

An Eloflex should primarily be used in its standard version. If the electric wheelchair needs to be adapted or changed in any way, it may only be carried out by your centre for assistive devices or by Eloflex. Please note that damage and errors that occur due to not following the instructions for use or due to poor maintenance are not covered by the warranty.

*Good luck and lots of pleasure with your Eloflex.*

**Drive carefully!**



Content	Page
Intended use	3
Fold it up and fold it together	4
Install the joystick controller	5
Charging instruction	5
Joystick	6
Navigate the menus	7
Change seat width	8
Adjust armrests	8
Change seat height	9
Manual driving	9
Anti-tipping devices	9
Backrest	10
Footrest	10
Transport and storage	11
Driving instructions	12-13
Safety instructions	14-15
Technical data	16
Contact	16

# Intended use

---

## Type classification and intended use

Eloflex power wheelchairs have been developed for people who have difficulty walking or cannot walk at all, but with vision, physical and mental ability to control an power wheelchair.

The Eloflex power wheelchair is compact and flexible enough for indoor use, but the chair is also suitable for outdoor use. In the chapter "Technical data" at the end of this document there is information on speed, turning radius, range, maximum climbing ability, maximum weight for the user etc. We encourage you to read all safety information in the "Safety Precautions" chapter of this document.

Eloflex has been tested and approved according to EN12184: 2014 - class B (indoor and outdoor use). Eloflex has also been approved according to ISO-7176, IEC60601, and the batteries have been approved according to UN38.3.

Eloflex power wheelchairs meet the applicable requirements in MDR 2017/745.

Classification of medical equipment class 1 and CE marking are carried out in accordance with Annex VIII Chapter III of MDR 2017/745. Conformity assessment procedure: Annexes II and III to MDR 2017/745. The CE marking becomes invalid if replacement components or accessories are used that have not been approved for this product.

## Requirements

The purpose of an Eloflex power wheelchair is to compensate for an injury or a disability, which is why it is recommended in the following circumstances:

- If the user has the inability to walk or severely limited ability to walk, which makes it difficult to move around in their own home.
- If there is a need to leave the home to get out in the open or to visit the places that are normally visited to carry out everyday tasks.
- When the user has difficulty getting to, or performing work or activities due to their mobility impairment.

It is suitable to use Eloflex power wheelchairs both indoors and outdoors, if it is not possible to use manually operated wheelchairs due to mobility problems, but it is still possible to operate electrically operated wheelchairs in a correct way.

## Accessories

Charger and bag with simple tools are available on delivery in the storage bag under the seat.

## Usability

Only use the Eloflex power wheelchair when it is in fully functional condition. Otherwise, you put yourself and others at risk. The following list does not include all possible situations. It only describes certain situations that may affect the usability of the electric wheelchair.

- Do not use the power wheelchair if the batteries are defective or deformed
- Do not use the power wheelchair if the engine runs jerkily or makes abnormal noise
- Do not use the power wheelchair if there appears to be a fault with the brake function
- Contact your centre for assistive devices or dealer if the tires are worn
- Contact your centre for assistive devices or dealer if you discover damage to the seat belt, armrest, seat, backrest, control lever or other part of the chair
- Contact your aid centre for assistive devices or dealer if you discover damage to the electrical system (cables, batteries, chargers etc.)

## Manufacturer's warranty

The Eloflex warranty replaces parts that are broken. The damage must not be caused by the user. The warranties do not cover damage caused by external circumstances such as theft, mismanagement, misuse, lightning or modification.

## Useful life

The calculated useful life of an Eloflex is five years. However, the product's useful life is largely affected by how it is used and cared for. An Eloflex can have a significantly longer useful life if you take care of it and only use it in line with the information in this document.

## Safety regulations and risks

READ THE DRIVING INSTRUCTIONS AND SAFETY REGULATIONS, FROM PAGE 12, CAREFULLY BEFORE YOU START USING YOUR ELOFLEX ELECTRIC WHEELCHAIR.



# Unfold and fold it together

## Unfold it

### Step 1

Place the folded wheelchair on the ground as shown on the illustration to the right. Grasp the backrest and pull upwards to open the chair. Hold on with one hand on the seat cushion.



### Step 2

Close the latch - this is very important!



## Fold up

### Step 1

Open the latch as shown in the pictures to the right.



### Step 2

Place one hand on the front edge of the seat cushion. Grasp the upper edge of the backrest with the other hand and fold it forward. Press the chair together according to the pictures on the right.



# Install joystick

## Step 1

Mount the joystick in the bracket under the armrest and tighten the screw.



## Step 2

Assemble the cable connectors and gently twist until the pins go into the holes and the grooves in the two connectors align. Then screw the sleeves on each connector together.



**IMPORTANT!**

**Be careful not to damage or bend the pins in the connector.**

# Charging instruction

## This is how you charge

Start by turning off your Eloflex. Plug the charger into the socket on the front of the joystick. Ensure that the position of the contacts match each other. Then insert the charger's power cable into a wall outlet.

Charging is indicated by a light on the charger. Red light means charging is in progress. After about three hours, the batteries are charged to 90 percent. The chair can now be used again.

After about 5-8 hours, the light on the charger turns green and the batteries are fully charged. During charging, the charger itself gets warm, and this is completely normal.



For maximum battery life, charging should take place for approximately five hours when the bar on the battery indicator on the display has gone down three bars. The batteries are not damaged by maintenance charging, but for maximum useful life we recommend that you disconnect the charger when



**IMPORTANT!**

**NEVER connect the charger directly to the battery.**

the batteries are fully charged. Charging the batteries can take place down to -10 degrees. When charging in lower temperatures, the batteries will not be fully charged. If your Eloflex is used at freezing temperatures, the mileage will be affected. At -10 degrees, for example, mileage can be reduced by up to 50%.

# Joystick



1

2

3

**1 Speed indicator:** All white bars = maximum speed.

**2 Trip meter:** The distance you have driven and current speed are shown here.

**3 Battery check:** Here it is indicated how much power is left in the batteries. When the batteries are fully charged, all bars are white. As the batteries are discharged, the bars go out in turn. Charge when three bars have gone out.

## USB contact

**TIPS:**  
By means of the USB connector on the underside of the joystick, you can charge your mobile phone.



Charging socket

Light



**Joystick:** controls the chair's speed and direction of travel.



**Increase the speed:** Press to increase the chair's maximum speed.



**Power on and off:** Press to turn your Eloflex on and off.



**Decrease the speed:** Press to decrease the chair's maximum speed.

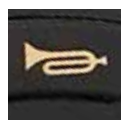

**Honk:** Push to call attention.



**On/off light:** Press to turn the lights on and off.

# Navigate the menus

---

## Change settings

You can change the chair's settings such as language, horn volume and measurement units.

1. To enter the settings, press the right multifunction button. A list of multiple choice options will then open.



2. In the multi-choice list, scroll up and down with the speed buttons.



3. Select function with the right multifunction key (Enter) or go back one step with the left multifunction key (Return).

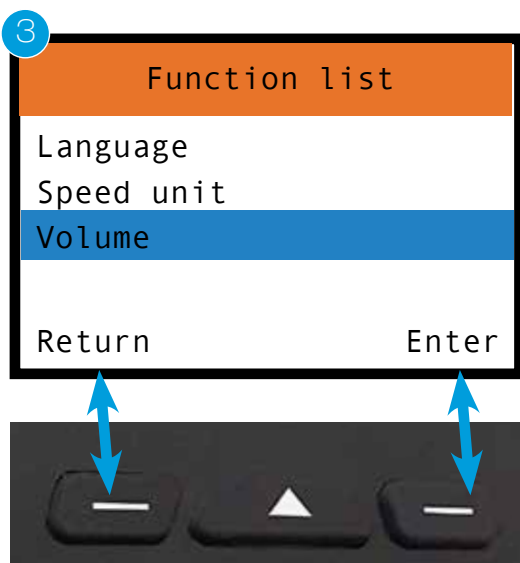

# Change seat width

---

To adjust the width of the seat, first loosen the screw under the seat and adjust the width by pulling the armrest outwards.



# Adjust the height of the armrest

---

To adjust the height of the armrest, pull the screw on the side of the armrest outwards and then raise/lower the armrest to the desired height. Here you can also loosen the armrest completely to make it easier to get in and out of the chair.



# Adjust the length of the armrest

---

To adjust the length of the armrest, press the button under the armrest and then drag the armrest horizontally to the desired position.





# Change seat height

To change the height of the seat, hold the speed button when the joystick is on. With the upper button you raise the seat, with the lower you lower the seat. Continue to hold the button until you have reached the desired height.

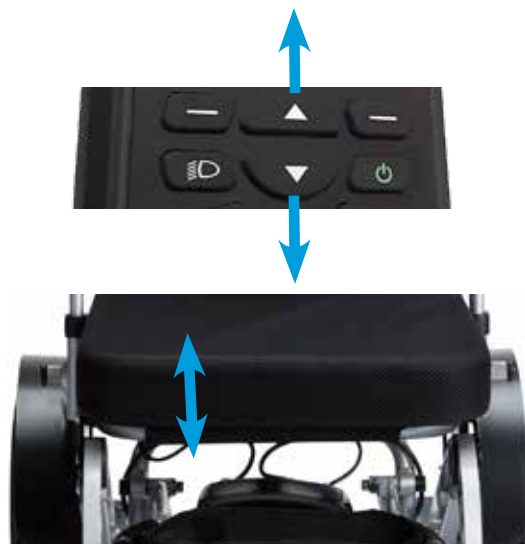

# Manual driving

Switch off the power wheelchair with the joystick. Then push forward the red levers on the engines (see picture) to disengage the magnetic brakes. In this position, the chair can be manually rolled freely.

**Note!** If the user uses the chair without assistance, the chair's magnetic locks must always be engaged.



# Anti-tipping devices

The anti-tipping devices have two settings. One when you drive and one when parked in an upright position after being folded. They automatically fold in when you place the chair upright in the folded position. For optimal security, the anti-tipping devices must always be in the extended position with the support wheel backwards while driving.



# Backrest

---

## Adjust the backrest

Adjust the angle of the back by pushing down the levers on the sides and position the backrest in an angled position that feels comfortable. Then release the levers to lock the position. You can choose between an angle between 2 and 22 degree



# Footrest

---

For easier entry and exit, the footrest can be folded up as shown in the image below.



## Adjust the footrest

Unscrew the screw and adjust to the desired height.



# Transport and storage

---

- To lift the chair, it is recommended to first fold the chair and then place it in an upright position. Then it is lifted.
- A folded chair can be put in the trunk of a car or placed in a wardrobe.
- If the chair is not to be used for a while, we recommend that the batteries are fully charged before putting the chair away.
- The chair should be stored indoors in frost-free, dry and ventilated areas. Storage temperature 0-30 degrees.
- If you are going to bring your Eloflex on an aircraft, we recommend that you read through the information we have compiled on our website regarding IATA's regulations [www.eloflex.se/faq](http://www.eloflex.se/faq)
- In case of transportation in a public transport or a bus for disabled persons, Eloflex must be fastened to the attachment points as shown in the pictures at the bottom. Please note that Eloflex is not tested as a car seat. We therefore always recommend that the user moves to the car's own seats.

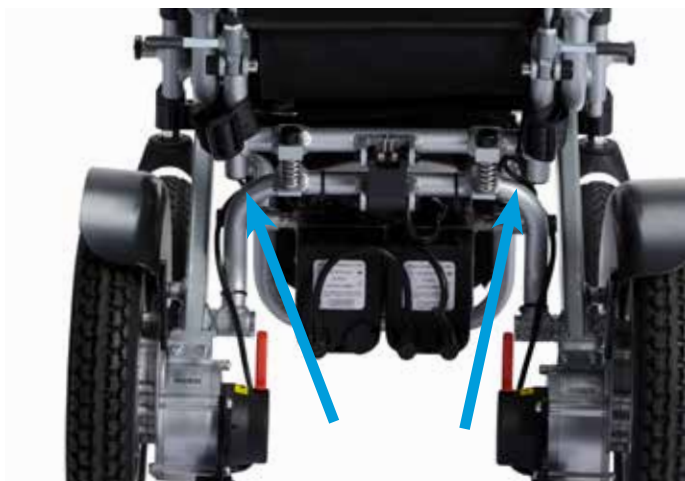

## Safety instructions when driving

---

There is a risk of personal injury due to the wheelchair tipping over.

- Only drive on inclines and gradients that do not exceed the maximum permitted gradient
- Always use the anti-tipping devices when driving with Eloflex
- Driving downhill should always be done at a lower speed
- Avoid stretches where there is a risk of icy or slippery surfaces
- Never attempt to drive up or down stairs with your power wheelchair
- Never drive over obstacles higher than the recommended maximum height
- Avoid quick or jerky movements with the joystick and sudden changes of direction while driving

Risk of being left standing in remote places.

- A user with severely reduced mobility should not drive alone for long distances outdoors.

Risk of injury if a foot slips off the footrest and ends up under the electric wheelchair during travel.

- Always place your feet in the centre of the footplate while driving

Risk of injury if you collide with other objects in narrow passages.

- Drive through narrow passages with the lowest speed and maximum attention

There is a risk of the wheelchair tipping over if the anti-tipping devices are dismantled, damaged or mounted in a position that deviates from the standard mounting.

- The anti-tipping devices must always be mounted when the electric wheelchair is used
- The anti-tipping devices only work on a firm surface. On soft surfaces such as lawns and snow, the anti-tipping device may lose its effectiveness. Therefore, drive extremely carefully on soft surfaces.



# Driving

---

## Read

**The user must read these safety and driving instructions before using the electric wheelchair from Eloflex.**

## Practice

Practice makes perfect. Practice driving the Eloflex with an assistant by starting on an open flat surface, preferably outdoors, before using your electric wheelchair with other people, in shops or restaurants etc.

Drive forward by slowly moving the joystick forward.

Stop by releasing the joystick.

## Reverse

Reverse by moving the joystick slowly backwards. To stop, release the joystick.

Remember to always look behind you before starting to reverse to ensure no person or object is in the way.

## Spin

Spin by moving the joystick gently sideways.

Be careful not to get in the way of the sides when you spin.

## Turn

Turn while driving by gently moving the joystick sideways in the direction you want to turn.

Always slow down when turning.

## Obstacle

Practice avoiding and passing obstacles. Move the joystick sideways while driving forward to avoid obstacles.

Remember to slow down when approaching obstacles.

## Fast driving

Push the joystick in the forward position if you want to drive fast.

Remember to pull back the joystick and reduce the speed as soon as you feel uncertain, if you are about to turn or if you are approaching an obstacle.

## Drive over obstacles

Drive slowly up to the obstacle and make sure the front wheels are in the direction of travel. Then slowly move the joystick forward while leaning back to drive over the obstacle.

Eloflex is tested and approved for obstacles up to a maximum of 6 cm.

## Driving on inclined surfaces

Try to drive straight up or straight down an inclined surface.

Lean slightly forward when driving uphill, and backwards when driving downhill, to maintain your centre of gravity.

Avoid driving sideways if possible and compensate for any side tilt by leaning in the opposite direction. Always drive slowly on inclined surfaces. Avoid surfaces that incline more than 9 degrees.

## Take the elevator

Remember to check the width of the elevator door and how quickly the door closes before entering the elevator.

Keep in mind that you may have to back out of the elevator if it is not large enough for you to turn around.

## Drive on the road

Drive primarily on pavements, footpaths and cycle paths and lastly on busy carriageways with your Eloflex.

## Cross the carriageway

If possible, always choose to cross the road at a pedestrian crossing. Be aware of crossing cars.

Use the bevelled part of the pavement if there is one.

Avoid curbs that are higher than 6 cm.

# SECURITY

## General safety instructions

There is a risk of personal injury if the power wheelchair is used for purposes other than those described in this document.

- Use the electric wheelchair only according to the instructions in this user manual (see above, chapter "Type classification and intended use")

There is a risk of personal injury if the power wheelchair is used with impaired driving ability.

- Do not use the wheelchair when your ability to drive is impaired due to, for example, illness, medication or alcohol.

There is a risk of personal injury if the power wheelchair is used with impaired driving ability.

- Switch off the wheelchair before getting on and off or if there is a risk that you, another person or an object could come into contact with the joystick
- When the engines are disengaged, the brakes do not work. Therefore, the wheelchair may only be pushed on level ground, never on slopes. Never leave the wheelchair on or near slopes with disconnected engines.

There is a risk of personal injury if the power wheelchair is switched off during travel with, for example, the on/off button or if a cable is torn off, as it stops with a hard jerk.

- Release the joystick when braking in an emergency. Then the wheelchair stops automatically.

There is a risk of personal injury due to the wheelchair tipping over.

- Do not move forward, bend forward between the knees or lean over the edge of the wheelchair, for example to reach objects.
- Always wear a seat belt and readjust it before each trip.
- Drive as close to the new seat as possible when transferring to another seat.

There is a risk of personal injury if the maximum permitted load is exceeded.

- Consider the maximum permissible load (see chapter "Technical data" at the back of this document).
- The electric wheelchair may only be used by a single person. Never use the wheelchair to transport more than one person at a time.

There is a risk of personal injury and damage to the wheelchair if the locking hook that is released when folding is not correctly fastened when the power wheelchair is used.

- If the locking hook of the electric wheelchair has not clicked into place properly, the chair may suddenly fold when in use, causing you to fall out of the wheelchair.
- Always ensure that the locking hook is in the correct position before using the electric wheelchair.

There is a risk of personal injury and crushing injuries when folding and unfolding the wheelchair.

- Always fold and unfold the electric wheelchair as described in the user manual.
- Be careful not to pinch anyone or anything when folding and unfolding.

There is a risk of personal injury and damage to the wheelchair if it is used in damp areas.

- The power wheelchair must not be used when showering.
- The power wheelchair must not be used when bathing.



# Security

---

## **Cross tramway/railway tracks**

Always cross the railway track straight ahead, never diagonally from the side. Never cross railway tracks alone, always have someone with you who can help you.

## **Sharp slopes**

Be careful when driving on a steep incline as the chair is at risk of tipping over. Eloflex is tested and approved for an incline up to a maximum of 9 cm. Always have someone with you who can help you.

## **High edges**

Be careful when driving up of or beside a curb. Eloflex is tested and approved for obstacles up to a maximum of 6 cm. Always have someone with you who can help you.

## **Movement**

We recommend that you always have someone who can help you when moving to and from your Eloflex. Always turn off the power before starting the move. Always raise the armrests and footrest before moving to make it easier to get in and out of the chair.

## **Do not make repairs yourself**

Never attempt to repair a broken power wheelchair on your own. If you screw or try to repair the chair yourself, the warranty does not apply. Always contact Eloflex or the shop or centre for assistive devices that sold/prescribed the chair. Never modify your electric wheelchair yourself.

## **Not a toy**

Never allow children who do not normally use an electric wheelchair to sit in or use your Eloflex.

## **Cleaning**

Never clean your Eloflex with running water. Only wipe it with a damp cloth. If your Eloflex is slow to fold up and fold, you can lubricate the joints with 5-56 or silicone spray.

## **Beware of heat**

Never leave your Eloflex in direct sunlight or near a heat source as the batteries may be damaged. Never be near open flames with your Eloflex.

You can use your Eloflex from -10 degrees up to +45 degrees. At freezing temperatures, the range can be affected by leaning in the opposite direction. Always drive slowly on inclined surfaces. Avoid surfaces that incline more than 9 degrees.

## **Storage**

Keep your Eloflex out of reach of children when not in use. The power wheelchair should be stored indoors in frost-free, dry and ventilated areas. Storage temperature 0-30 degrees.

## **The charger**

The charger must never be covered when used to charge your Eloflex. The charger gets hot and there is a risk of accident or injury.

## **Batteries**

Never store the batteries in direct sunlight or in a place that can reach freezing temperatures. The batteries must be stored in a dry and ventilated place.

# Technical data

---

## MODEL K

<b>Load weight</b>	26 kg without batteries
<b>Total weight</b>	29 kg with batteries
<b>Range</b>	30 km
<b>Max user weight</b>	90 kg
<b>Speed</b>	6.5 km/h
<b>Motor</b>	2 x brushless motors
<b>Motor effect</b>	2 x 250 Watt
<b>Battery</b>	2 x Lithium ION 10AH/24V
<b>Battery power</b>	2 x 240 Wh
<b>Charging time</b>	3 hours
<b>Turning radius</b>	60 cm
<b>Wheel</b>	front 8" gel, rear 12" air
<b>Seat height</b>	47-52 cm
<b>Seat width</b>	36-44 cm
<b>Seat depth</b>	36 cm
<b>Backrest</b>	Adjustable 2-22 degrees
<b>Measures</b>	98.5 x 55 x 89 cm
<b>Measures folded</b>	75x55x36 cm

---

## © Copyright Eloflex

This document contains information protected by copyright and may not be copied or reproduced in whole or in part without the written permission of Eloflex.

Eloflex reserves the right for any typographical errors in this document and we reserve the right to make product changes.

## Contact Eloflex

If you have questions or need help, we ask that you contact your centre for assistive devices or dealer in the first instance. If you want to have direct contact with us, you will find contact information on our website [www.eloflex.eu](http://www.eloflex.eu).



2021-05-08  
Version 2.0  
Sungo Europe B.V.  
Olympisch Stadion 24, 1076DE  
Amsterdam, the Netherlands  
SRN:NL-AR-000000247

Kunshan Aoshida Electric Technology Co., Ltd  
No. 108 Matang Road, Penglang Town, Development Zone, Kunshan City, Jiangsu



**Eloflex**  
**Hammarbacken 4B**  
**191 49 Sollentuna, Sweden**